

ITEM NO.	QTY.	PART NO.	DESCRIPTION
1	1	010490	1/2-13x6-1/2"HHCS GR5
2	1	000573	1/2" SPRING LOCK WASHER
3	1	000551	1/2-13 GRADE 5 HEX NUT (ZINC)
4	1	010324	0.19"x3"x3" PLATE(CANTILEVER)
5	1	011928	EMERGENCY CHAIN UP CHANNEL (CANTILEVER)
6	1	000572	3/8" SPRING LOCK WASHER
7	1	000550	3/8-16 GR5 HEX NUT
8	1	000517	3/8-16x2-1/2"HHCS GR5
9	1	011927	CHAIN-7MMx5 LINKS-ZINC (CANTILEVER)

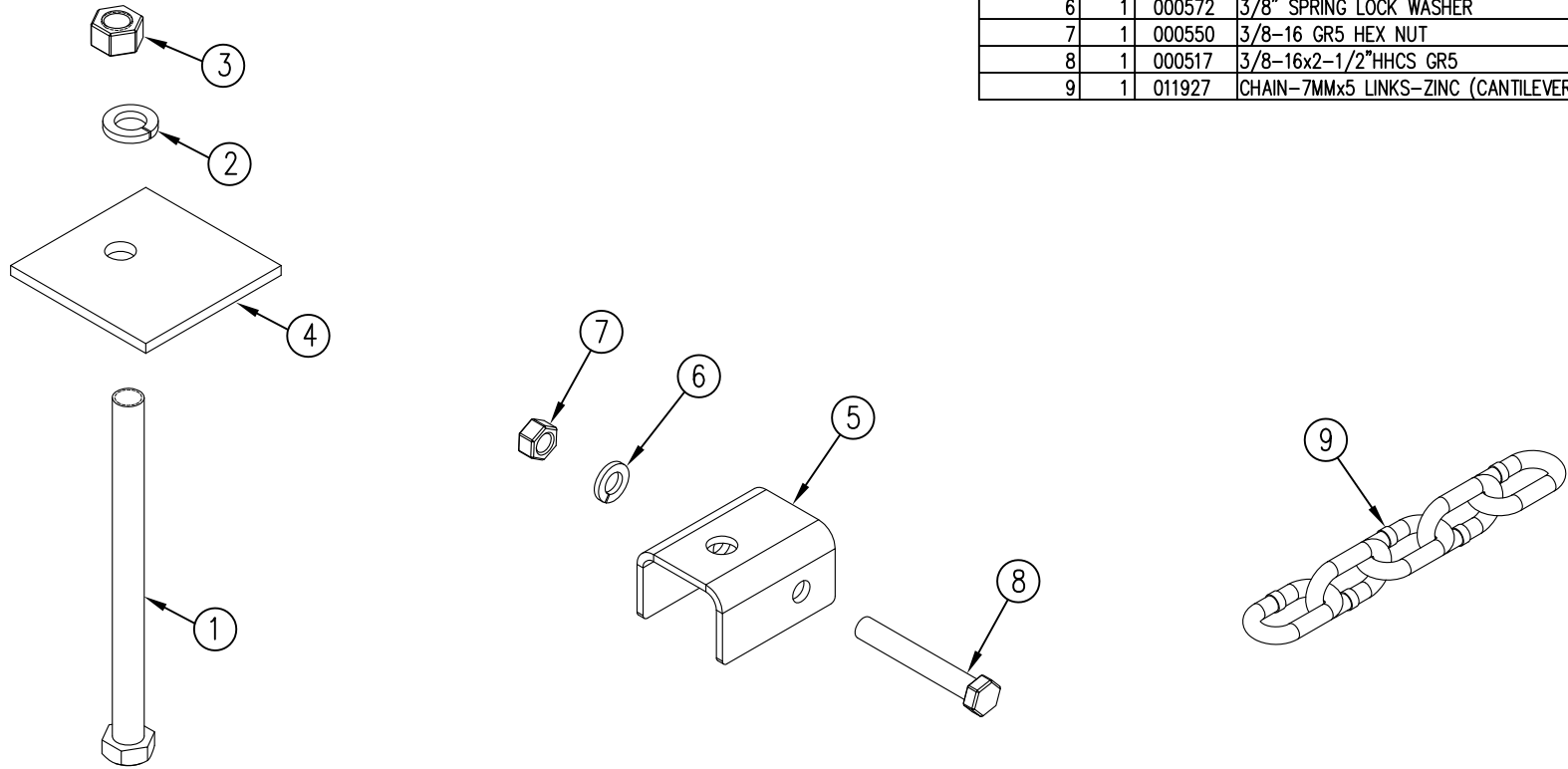

				THIRD ANGLE PROJECTION			FILENAME:				WOODBINE MFG. CO. BUS BROWN DRIVE WOODBINE, IOWA 51579															
							SYMBOLY PER ANSI Y14.5				NOTES:															
				<table border="1"> <tr> <th>DECIMAL</th> <th>2PLC</th> <th>3PLC</th> </tr> <tr> <td>MACHINE SAW, DRILL</td> <td>.030</td> <td>.015</td> </tr> <tr> <td>SHEAR, PUNCH FORM</td> <td>.060</td> <td>.030</td> </tr> <tr> <td>TORCH, WELDING ROUGH CAST</td> <td>.090</td> <td>.060</td> </tr> </table>			DECIMAL	2PLC	3PLC	MACHINE SAW, DRILL	.030	.015	SHEAR, PUNCH FORM	.060	.030	TORCH, WELDING ROUGH CAST	.090	.060	DRAWN BY: JCB				712-647-2050			
DECIMAL	2PLC	3PLC																								
MACHINE SAW, DRILL	.030	.015																								
SHEAR, PUNCH FORM	.060	.030																								
TORCH, WELDING ROUGH CAST	.090	.060																								
							DRAWN/DATE 6/2/15				THE INFORMATION HERE IS CONFIDENTIAL AND MUST NOT BE USED IN ANYWAY DETRIMENTAL TO THE INTEREST OF WOODBINE MFG.															
							APPVD/DATE				TITLE CANTILEVER REPLACEMENT CHAIN-UP FEATURE															
A	6/2/15	RELEASED TO PRODUCTION				JCB		1406	SALES CATEGORY				PRODUCT LINE	SCALE 1:3	FIN. WT.	PART NO. 14436										
REV.	DATE	CHANGE RECORD				BY	APPVD	ECN	DRAFT 2"		ANGULAR ±1"															