

ITEM NO.	QTY.	PART NO.	DESCRIPTION
1	1	011190	REAR COVER NISSAN
2	4	000589	3/8-16X1-3/4 HHCS, ZP
3	8	000550	3/8-16 GR5 HEX NUT
4	4	000572	3/8" SPRING LOCK WASHER
5	4	000575	3/8 USS FLAT WASHER
6	2	011198	SPACER/.68X.31
7	2	011199	SPACER/.25X.31

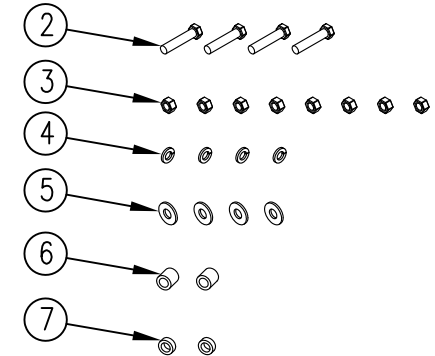
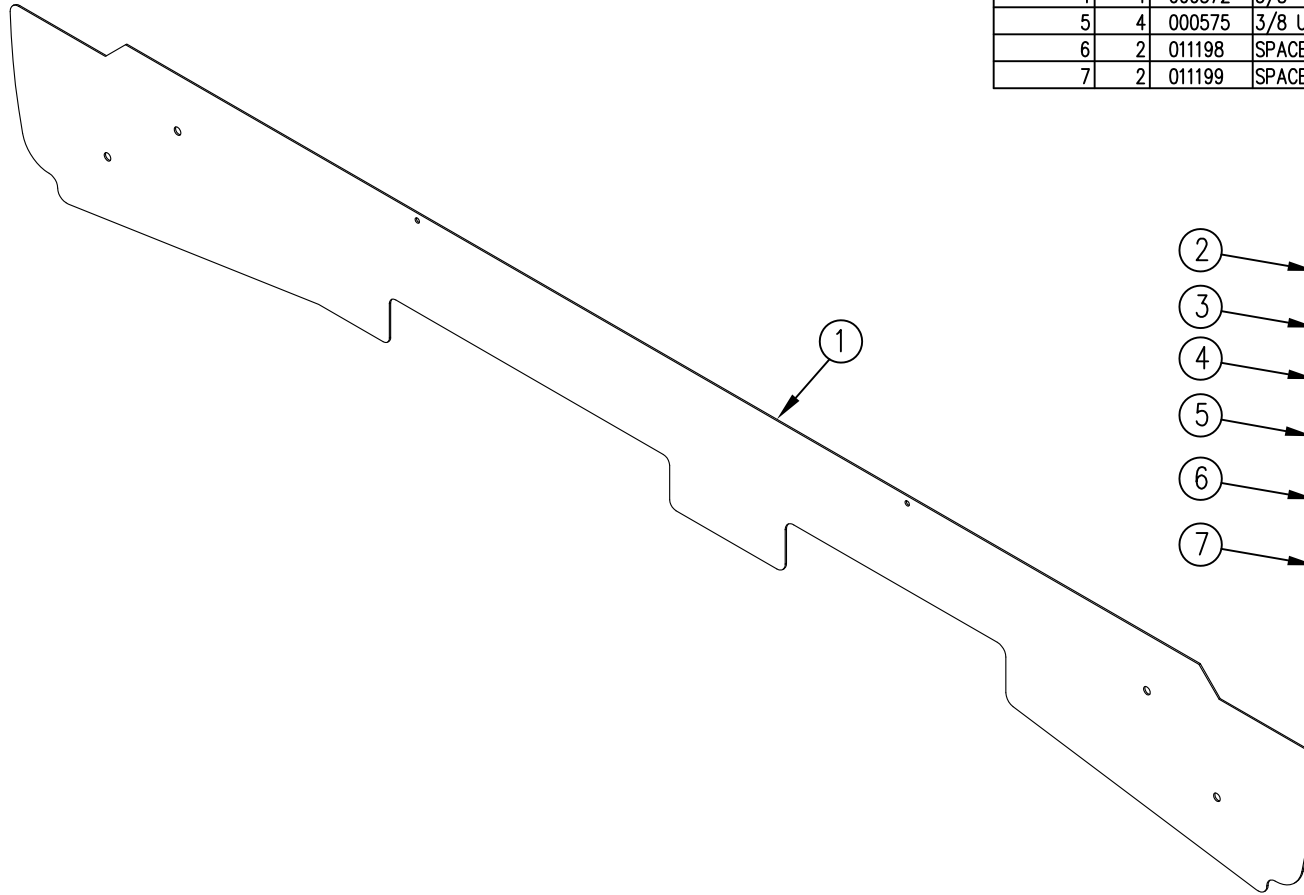

				THIRD ANGLE PROJECTION			FILENAME:				WOODBINE MFG. CO. BUS BROWN DRIVE WOODBINE, IOWA 51579																			
							SYMBOLY PER ANSI Y14.5				NOTES:																			
				<table border="1"> <tr> <th>DECIMAL</th> <th>2PLC</th> <th>3PLC</th> </tr> <tr> <td>MACHINE SAW, DRILL</td> <td>.030</td> <td>.015</td> </tr> <tr> <td>SHEAR, PUNCH FORM</td> <td>.060</td> <td>.030</td> </tr> <tr> <td>TORCH, WELDING ROUGH CAST</td> <td>.090</td> <td>.060</td> </tr> </table>			DECIMAL	2PLC	3PLC	MACHINE SAW, DRILL	.030	.015	SHEAR, PUNCH FORM	.060	.030	TORCH, WELDING ROUGH CAST	.090	.060	DRAWN BY. JCB				712-647-2050							
DECIMAL	2PLC	3PLC																												
MACHINE SAW, DRILL	.030	.015																												
SHEAR, PUNCH FORM	.060	.030																												
TORCH, WELDING ROUGH CAST	.090	.060																												
							DRAWN/DATE 3/11/14				<small>THE INFORMATION HERE IS CONFIDENTIAL AND MUST NOT BE USED IN ANYWAY DETRIMENTAL TO THE INTEREST OF WOODBINE MFG.</small>																			
A				3/11/14				RELEASED TO PRODUCTION				JCB																		
							APPVD/DATE				TITLE REPLACEMENT REAR COVER (CANTILEVER-N)																			
REV.				DATE				CHANGE RECORD				BY APPVD ECN																		
				DRAFT 2'			ANGULAR ±1'			SALES CATEGORY		PRODUCT LINE		SCALE 1:8		FIN. WT.		PART NO. 13666												