

ITEM NO.	QTY.	PART NO.	DESCRIPTION
1	1	012883	89 55+12 ALUM TA PLATFORM COMP W/BOLT ON TAPER(TX)
2	2	013593	1/2-13X2' FLHD SHCS-ZINC PLATED
3	2	013344	1/2-13X1' FLHD SHCS-ZINC PLATED
4	1	013105	PLATED 5/8' SQUARE RAIL DUAL TORSION SPRING HOLDER
5	1	013106	PLATED 1/2' SQUARE RAIL DUAL TORSION SPRING HOLDER
6	4	000573	1/2' SPRING LOCK WASHER
7	2	000551	1/2-13 GR5 HEX NUT (ZINC)
8	1	013595	5/8"x89' RAIL TORSION SPRING (DUAL)
9	1	013594	1/2"x89' RAIL TORSION SPRING (DUAL)
10	2	000553	3/8-16 LARGE FLANGE LOCK NUT
11	2	012649	3/8-16x2-1/2' USS SOC HD CAP
12	1	007265	PLATED 1/2' TORSION SPRING HOLDER-PASSENGER
13	4	012238	.375"x1.75"x2' ALUM RAIL FLAT STOP(TX)
14	2	009540	CAUTION DECAL - TORSION SPRING
15	1	007019	PLATED 5/8' TORSION SPRING HOLDER- PASSENGER
16	2	013104	PLATED RAIL SPRING ARM(FIXED-DS)
17	6	000582	1-1/2' NARROW RIM MACHINE BUSHING
18	2	000521	1/2-13x1-1/4' HHCS GR5
19	2	013086	.13"x5"x36' DUAL TORSION SPRING COVER (TX)
20	16	004733	3/16"x5/8' POP RIVET
21	2	013291	5/16' TORSION SPRING SPACER
22	2	004721	1/8"x3/4' COTTER PIN
23	1	095133	(R)REPAIR TX RAILGATE TA SPRING INSTRUCTIONS

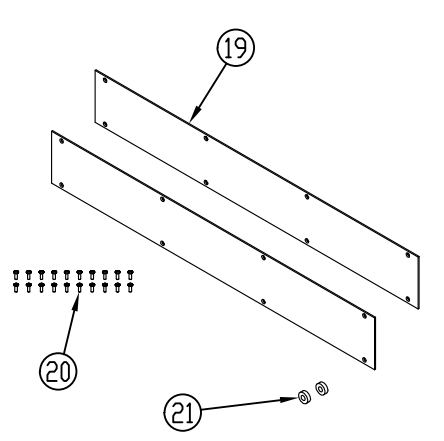

REV.	DATE	CHANGE RECORD	BY	APPVD	ECN	DRAFT	ANGULAR	SALES CATEGORY	PRODUCT LINE	SCALE	FIN. WT.	PART NO.												
C	9/2/15	4733 WAS 13074	GDB		1474	2'	±1°			1:15		013101												
B	8/4/15	013104 WAS 011155	GDB		1458																			
A	2/18/14	RELEASED TO PRODUCTION	GDB		1044																			
						THIRD ANGLE PROJECTION		FILENAME:		WOODBINE MFG. CO.														
								SYMBOLY PER ANSI Y14.5		BUS BROWN DRIVE														
						<table border="1"> <tr><td>DECIMAL</td><td>2PLC</td><td>3PLC</td></tr> <tr><td>MACHINE SAW,DRILL</td><td>.030</td><td>.015</td></tr> <tr><td>SHEAR, PUNCH FORM</td><td>.060</td><td>.030</td></tr> <tr><td>TORCH, WELDING ROUGH CAST</td><td>.090</td><td>.060</td></tr> </table>		DECIMAL	2PLC	3PLC	MACHINE SAW,DRILL	.030	.015	SHEAR, PUNCH FORM	.060	.030	TORCH, WELDING ROUGH CAST	.090	.060	DRAWN BY: GDB		NOTES:		
DECIMAL	2PLC	3PLC																						
MACHINE SAW,DRILL	.030	.015																						
SHEAR, PUNCH FORM	.060	.030																						
TORCH, WELDING ROUGH CAST	.090	.060																						
						DRAWN/DATE: 2/18/14		APPVD/DATE:		712-647-2050														
						SALES CATEGORY:		TITLE: (89) 55+12 TA REP EA PLFRM W/ BOLT ON TAPER(TX)																
										THE INFORMATION HERE IS CONFIDENTIAL AND MUST NOT BE USED IN ANYWAY DETRIMENTAL TO THE INTEREST OF WOODBINE MFG.														