

ITEM NO.	QTY.	PART NO.	DESCRIPTION
1	1	011557	UPPER ARM ASSY INSIDE - PASS
2	1	011555	UPPER ARM ASSY OUTSIDE - PASS
3	2	004733	3/16"x5/8" POP RIVET
4	1	011597	0.25x2.00x2.75"PLATFORM REST PAD(TUCKUNDER)
5	1	011595	TU FOLDED PLATFORM REST
6	6	000509	3/8-16x1"HHCS GR5
7	8	000605	3/8-16 USS LOCK NUT
8	4	000576	1/2" USS FLAT WASHER
9	4	000575	3/8 USS FLAT WASHER
10	2	012810	ZINC PLATED PIN CLIP (TUCKUNDER)
11	1	011531	1.24"DIA.x7.13" TRUNNION TUBE PIN (TUCKUNDER)
12	4	000587	1/2-13x1" HHCS GR5
13	4	000588	1/2-13 CROWN LOCK NUT
14	1	013019	3/8-16 X 3-1/2" SOCKET HEAD CAP SCREW
15	1	010046	3/8-16x3-1/2" HHCS GR5
16	1	011527	PLATFORM PIN (TUCKUNDER)
17	1	011499	PIVOT ARM SPACER

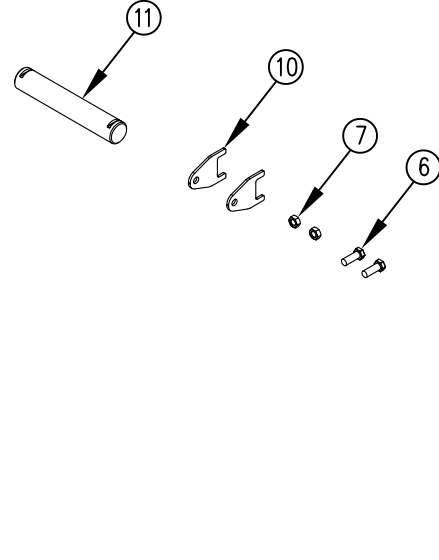

REV.	DATE	CHANGE RECORD	BY	APPVD	ECN	THIRD ANGLE PROJECTION	FILENAME:	SYMBOLY PER ANSI Y14.5	NOTES:	WOODBINE MFG. CO. BUS BROWN DRIVE WOODBINE, IOWA 51579																			
B	3/9/20	587 (4) WAS 521 (4)	AAS		2444	<table border="1"> <tr> <td>DECIMAL</td> <td>2PLC</td> <td>3PLC</td> </tr> <tr> <td>MACHINE SAW,DRILL</td> <td>.030</td> <td>.015</td> </tr> <tr> <td>SHEAR, PUNCH FORM</td> <td>.060</td> <td>.030</td> </tr> <tr> <td>TORCH, WELDING ROUGH CAST</td> <td>.090</td> <td>.060</td> </tr> </table>	DECIMAL	2PLC	3PLC	MACHINE SAW,DRILL	.030	.015	SHEAR, PUNCH FORM	.060	.030	TORCH, WELDING ROUGH CAST	.090	.060	<table border="1"> <tr> <td>DRAWN BY.</td> <td>JCB</td> </tr> <tr> <td>DRAWN/DATE</td> <td>3/10/14</td> </tr> <tr> <td>APPVD/DATE</td> <td></td> </tr> </table>	DRAWN BY.	JCB	DRAWN/DATE	3/10/14	APPVD/DATE		<table border="1"> <tr> <td>TITLE</td> <td>REPL. UPPER ARM W/PINS & KEEPERS(TKT) RT</td> </tr> </table>	TITLE	REPL. UPPER ARM W/PINS & KEEPERS(TKT) RT	<p>THE INFORMATION HERE IS CONFIDENTIAL AND MUST NOT BE USED IN ANYWAY DETRIMENTAL TO THE INTEREST OF WOODBINE MFG.</p>
DECIMAL	2PLC	3PLC																											
MACHINE SAW,DRILL	.030	.015																											
SHEAR, PUNCH FORM	.060	.030																											
TORCH, WELDING ROUGH CAST	.090	.060																											
DRAWN BY.	JCB																												
DRAWN/DATE	3/10/14																												
APPVD/DATE																													
TITLE	REPL. UPPER ARM W/PINS & KEEPERS(TKT) RT																												
A	3/10/14	RELEASED TO PRODUCTION	JCB		1075	<table border="1"> <tr> <td>DECIMAL</td> <td>2PLC</td> <td>3PLC</td> </tr> <tr> <td>MACHINE SAW,DRILL</td> <td>.030</td> <td>.015</td> </tr> <tr> <td>SHEAR, PUNCH FORM</td> <td>.060</td> <td>.030</td> </tr> <tr> <td>TORCH, WELDING ROUGH CAST</td> <td>.090</td> <td>.060</td> </tr> </table>	DECIMAL	2PLC	3PLC	MACHINE SAW,DRILL	.030	.015	SHEAR, PUNCH FORM	.060	.030	TORCH, WELDING ROUGH CAST	.090	.060	<table border="1"> <tr> <td>DRAWN BY.</td> <td>JCB</td> </tr> <tr> <td>DRAWN/DATE</td> <td>3/10/14</td> </tr> <tr> <td>APPVD/DATE</td> <td></td> </tr> </table>	DRAWN BY.	JCB	DRAWN/DATE	3/10/14	APPVD/DATE		<table border="1"> <tr> <td>TITLE</td> <td>REPL. UPPER ARM W/PINS & KEEPERS(TKT) RT</td> </tr> </table>	TITLE	REPL. UPPER ARM W/PINS & KEEPERS(TKT) RT	
DECIMAL	2PLC	3PLC																											
MACHINE SAW,DRILL	.030	.015																											
SHEAR, PUNCH FORM	.060	.030																											
TORCH, WELDING ROUGH CAST	.090	.060																											
DRAWN BY.	JCB																												
DRAWN/DATE	3/10/14																												
APPVD/DATE																													
TITLE	REPL. UPPER ARM W/PINS & KEEPERS(TKT) RT																												
<table border="1"> <tr> <td>THE INFORMATION HERE IS CONFIDENTIAL AND MUST NOT BE USED IN ANY WAY DETRIMENTAL TO THE INTEREST OF WOODBINE MFG.</td> <td>SCALE</td> <td>1:10</td> <td>WEIGHT</td> <td>-</td> <td>PART NO.</td> <td>12914</td> </tr> </table>						THE INFORMATION HERE IS CONFIDENTIAL AND MUST NOT BE USED IN ANY WAY DETRIMENTAL TO THE INTEREST OF WOODBINE MFG.	SCALE	1:10	WEIGHT	-	PART NO.	12914																	
THE INFORMATION HERE IS CONFIDENTIAL AND MUST NOT BE USED IN ANY WAY DETRIMENTAL TO THE INTEREST OF WOODBINE MFG.	SCALE	1:10	WEIGHT	-	PART NO.	12914																							