

ITEM NO.	QTY.	PART NO.	DESCRIPTION
1	1	011556	UPPER ARM ASSY OUTSIDE – DRIVER
2	1	011558	UPPER ARM ASSY INSIDE – DRIVER
3	2	004733	3/16"x5/8" POP RIVET
4	1	011597	0.25x2.00x2.75"PLATFORM REST PAD(TUCKUNDER)
5	1	011595	TU FOLDED PLATFORM REST
6	6	000509	3/8-16x1"HHCS GR5
7	8	000605	3/8-16 USS LOCK NUT
8	4	000576	1/2" USS FLAT WASHER
9	4	000575	3/8 USS FLAT WASHER
10	2	012810	ZINC PLATED PIN CLIP (TUCKUNDER)
11	1	011531	1.24"DIA.x7.13" TRUNNION TUBE PIN (TUCKUNDER)
12	4	000587	1/2-13x1" HHCS GR5
13	4	000588	1/2-13 CROWN LOCK NUT
14	1	013019	3/8-16 X 3-1/2" SOCKET HEAD CAP SCREW
15	1	010046	3/8-16x3-1/2" HHCS GR5
16	1	011527	PLATFORM PIN (TUCKUNDER)
17	1	011499	PIVOT ARM SPACER

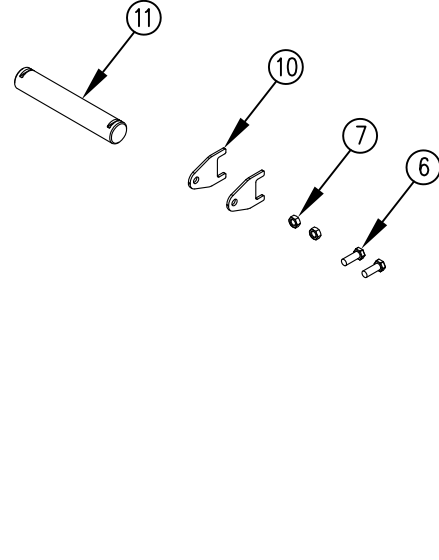

						THIRD ANGLE PROJECTION	FILENAME:	WOODBINE MFG. CO. BUS BROWN DRIVE WOODBINE, IOWA 51579	
							SYMBOLY PER ANSI Y14.5	NOTES:	
						DECIMAL MACHINE SAW,DRILL	2PLC .030	3PLC .015	DRAWN BY. JCB
B	3/9/20	587 (4) WAS 521 (4)	AAS	2444		SHEAR, PUNCH FORM	.060	.030	DRAWN/DATE 3/10/14
A	3/10/14	RELEASED TO PRODUCTION	JCB	1075		TORCH, WELDING ROUGH CAST	.090	.060	APPVD/DATE
REV.	DATE	CHANGE RECORD	BY	APPVD	ECN	THE INFORMATION HERE IS CONFIDENTIAL AND MUST NOT BE USED IN ANY WAY DETRIMENTAL TO THE INTEREST OF WOODBINE MFG.		SCALE 1:10	WEIGHT -
									TITLE REPL. UPPER ARM W/PINS & KEEPERS(TKT) LEFT
									PART NO. 12913



THE INFORMATION HERE IS CONFIDENTIAL AND MUST NOT BE USED IN ANYWAY DETRIMENTAL TO THE INTEREST OF WOODBINE MFG.