

ITEM NO.	QTY.	PART NO.	DESCRIPTION
1	2	011494	FOUR BAR PLATFORM LINK (TUCKUNDER)
2	2	011532	1.24"DIA.x2.88" LOWER ARM PIN (TUCKUNDER)
3	2	013050	ZINC PLATED 10GA.x1.88x3.38" PIN CLIP (TUCKUNDER)
4	2	010316	1.250" EXTERNAL SNAP RING ZP
5	2	013019	3/8-16 X 3-1/2" SOCKET HEAD CAP SCREW
6	2	010046	3/8-16 X 3-1/2" HHCS GR5
7	2	000509	3/8-16x1"HHCS GR5
8	6	000605	3/8-16 USS LOCK NUT

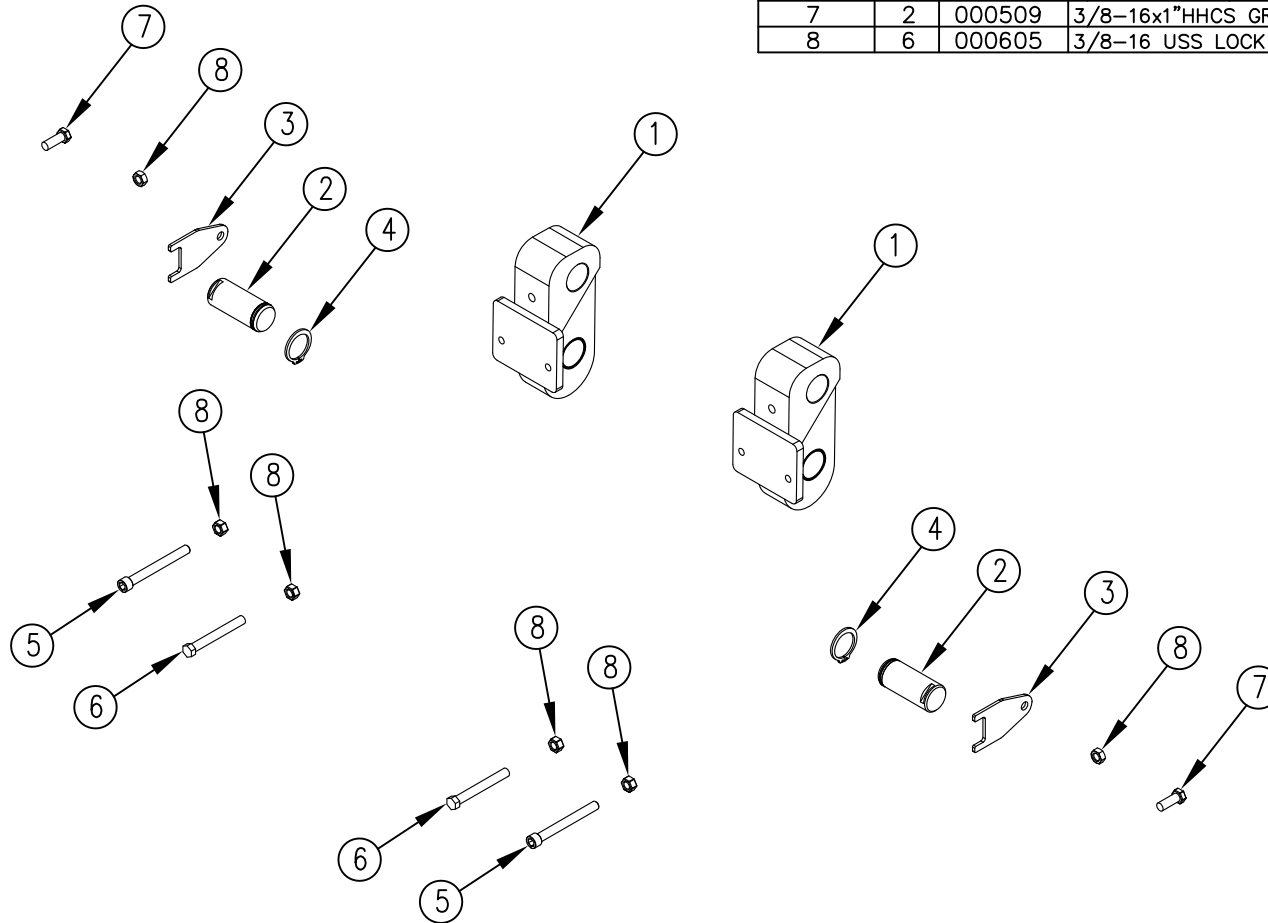

						THIRD ANGLE PROJECTION	FILENAME:	WOODBINE MFG. CO. BUS BROWN DRIVE WOODBINE, IOWA 51579	
							SYMBOLY PER ANSI Y14.5	NOTES:	
						DECIMAL MACHINE SAW,DRILL	2PLC .030	3PLC .015	DRAWN BY: JCB
B	3/6/15	13050 WAS 11527 IN ERROR	AAS	1340		SHEAR, PUNCH FORM	.060	.030	DRAWN/DATE 3/10/14
A	3/10/14	RELEASED TO PRODUCTION	JCB	1075		TORCH, WELDING ROUGH CAST	.090	.060	APPVD/DATE
REV.	DATE	CHANGE RECORD	BY	APPVD	ECN	DRAFT 2"	ANGULAR ±1"	SALES CATEGORY	TITLE REPLACEMENT PLATFORM LINK KIT (TUCKUNDER)
								PRODUCT LINE	SCALE 1:8
								FIN. WT.	PART NO. 12912



712-647-2050  
THE INFORMATION HERE IS CONFIDENTIAL AND MUST NOT BE USED IN ANYWAY DETRIMENTAL TO THE INTEREST OF WOODBINE MFG.