

ITEM NO.	QTY.	PART NO.	DESCRIPTION
1	1	9075	1-3/8" DIA BLACK KNOB
2	1	7531	3/8"x3" STUD FOR KNOB(650)
3	1	3823	2" COMPRESSION SPRING
4	1	1489	.755"DIA.x1.50"THD LATCH PIN(650)
5	1	95057	REPLACEMENT/RETRO FIT PIVOT PIN INSTRUCTIONS

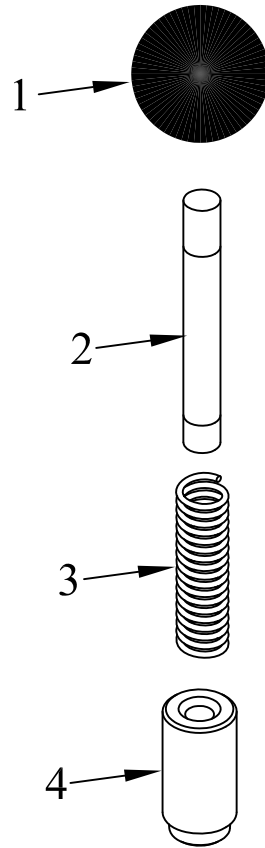

REV.	DATE	CHANGE RECORD	BY	APPVD	ECN	DRAFT	ANGULAR	FILENAME:	SYMBOLY PER ANSI Y14.5	NOTES:	TITLE	SCALE	FIN. WT.	PART NO.
B	1/19/10	ADDED PN095057	MTC		253	2'	±1'	THIRD ANGLE PROJECTION	DRAWN BY. DJR		650 PIVOT LATCH KIT	N		2482
								MACHINE SAW, DRILL	DRAWN/DATE 7/19/05					
								SHEAR, PUNCH FORM						
								TORCH, WELDING ROUGH CAST						

WOODBINE MFG. CO.  
 BUS BROWN DRIVE  
 WOODBINE, IOWA 51579  
 712-647-2050

THE ORIGINAL  
**TOMMY GATE**  
 hydraulic lift

THE INFORMATION HERE IS CONFIDENTIAL AND MUST NOT BE USED IN ANYWAY DETRIMENTAL TO THE INTEREST OF WOODBINE MFG.